

The Mi7 Pivot Ball Conversion offers a substantial weight saving, improved suspension geometry, flex characteristics, and easier maintenance.

Bumper Modification

The bumper must be modified to clear the front wishbones. Using a scalpel or dremel, remove material as shown, paying attention to the 25° angle.

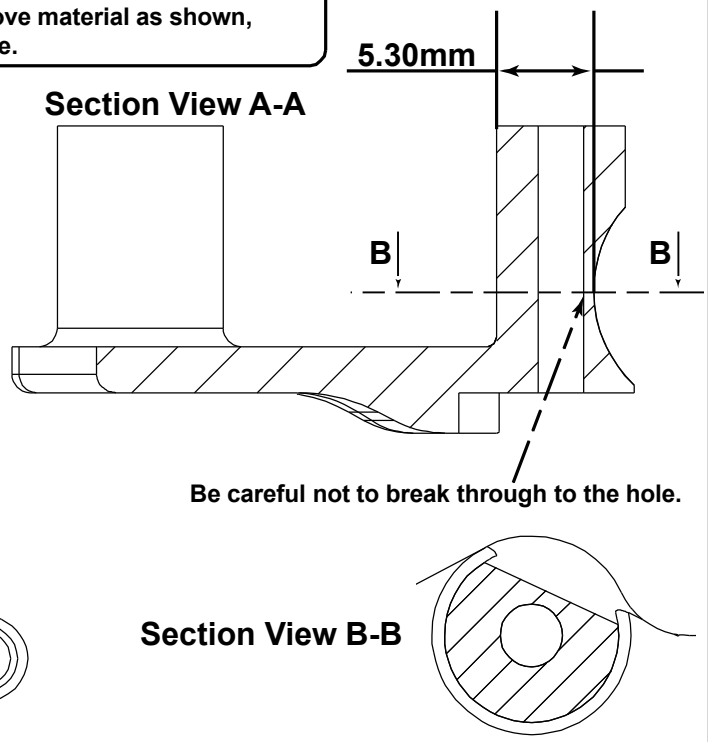
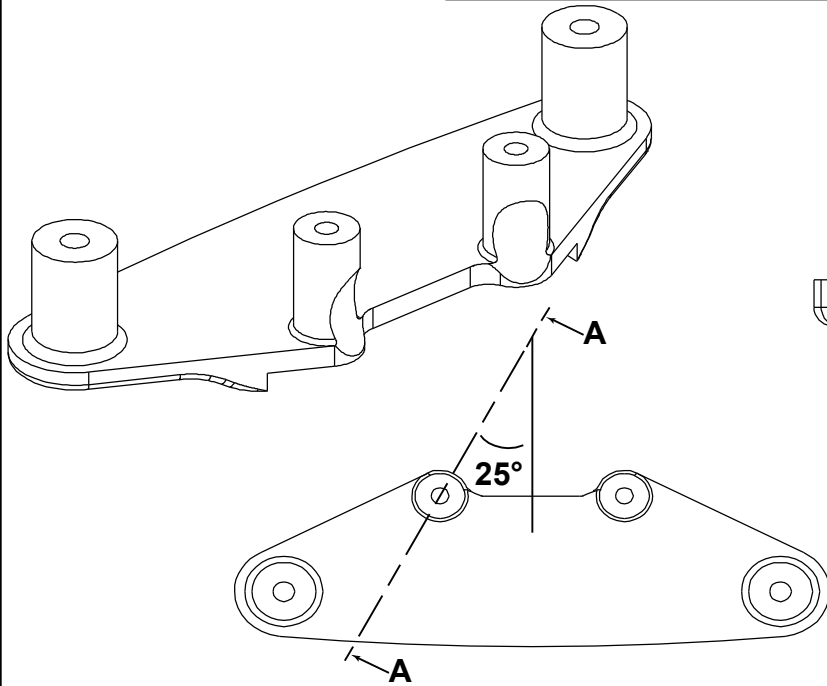

Bag A - Step 1

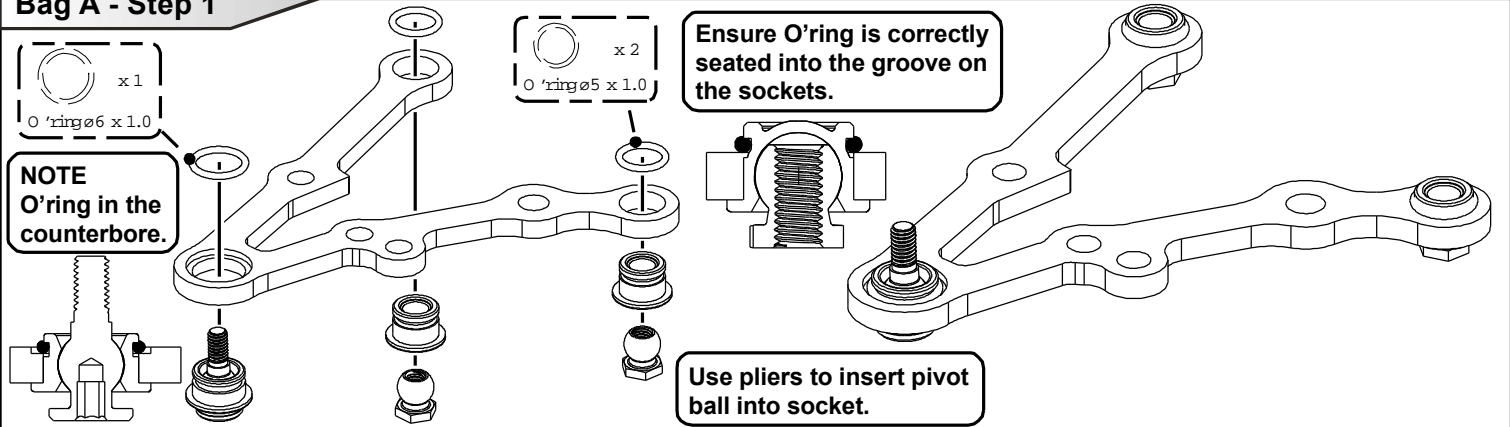

Bag A - Step 2

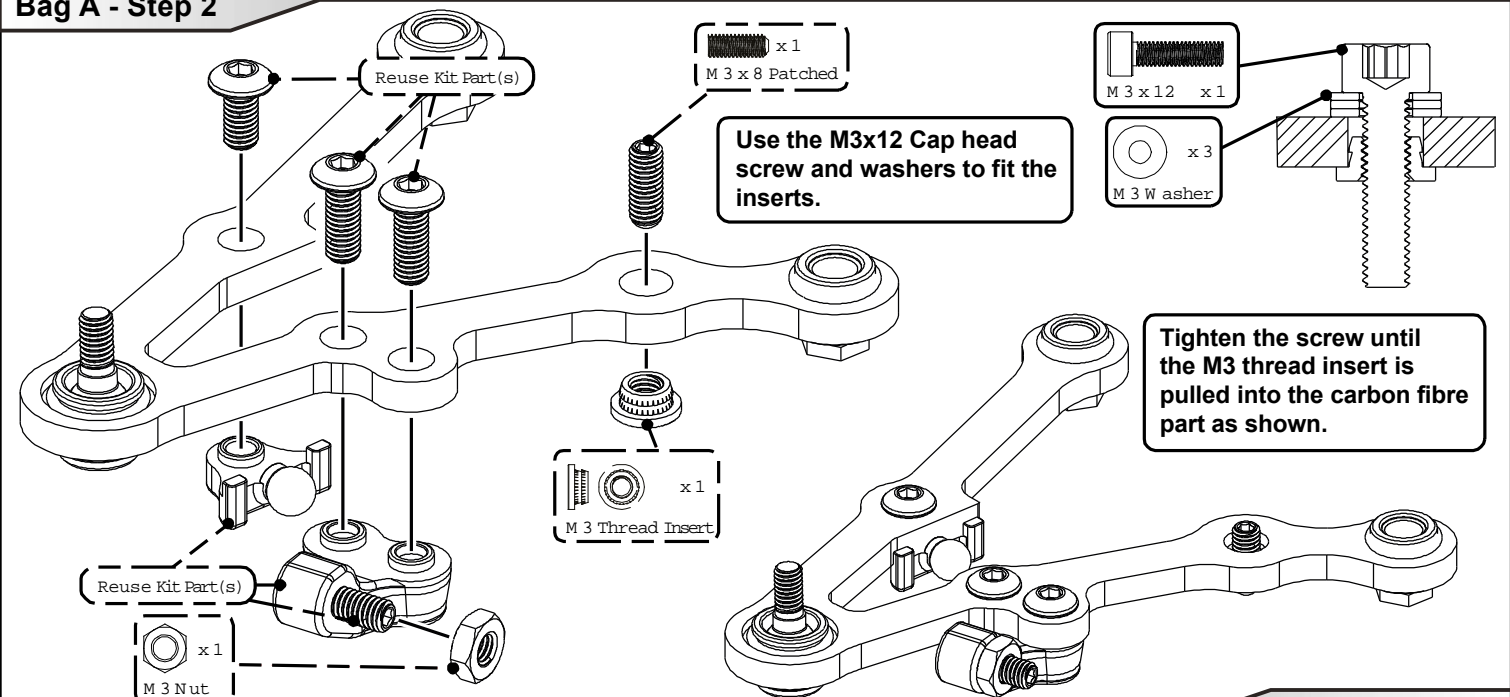

Bag A - Step 3

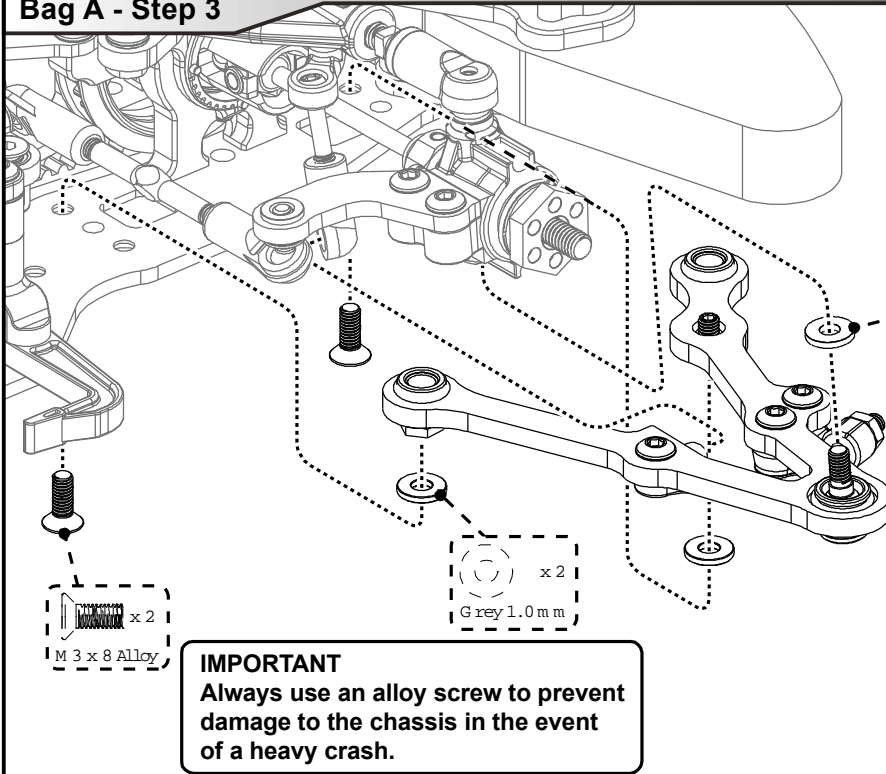

IMPORTANT
Only use the Ball Stud Washer (Shiny, silver, magnetic washer) in the specified location. If a normal washer is used it will lock up the ball joint.

x 1
Ball Stud Washer

x 2
M 3 x 8 Alloy

x 2
Grey 1.0mm

IMPORTANT
Always use an alloy screw to prevent damage to the chassis in the event of a heavy crash.

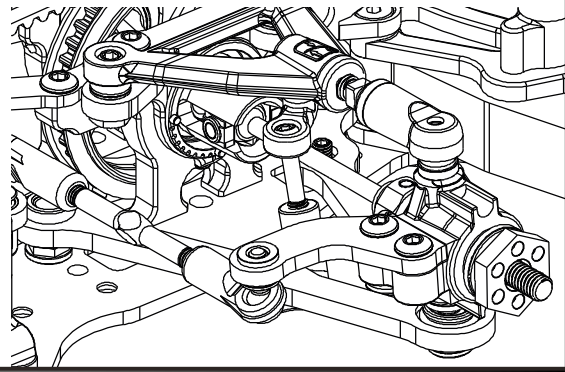

Bag B - Step 1

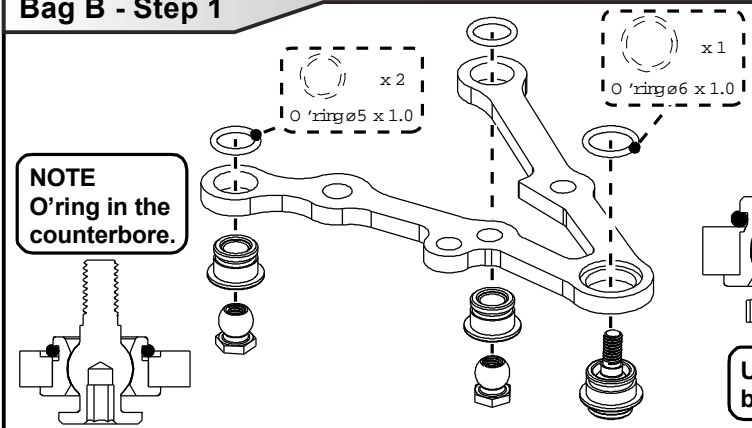

NOTE
O'ring in the counterbore.

x 2
O'ring $\varnothing 5 \times 1.0$

x 1
O'ring $\varnothing 6 \times 1.0$

Ensure O'ring is correctly seated into the groove on the sockets.

Use pliers to insert pivot ball into socket.

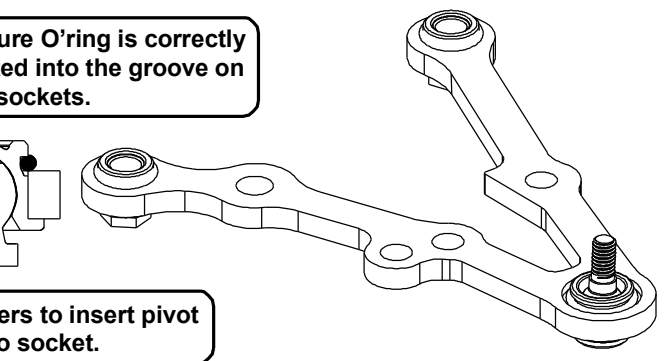

Bag B - Step 2

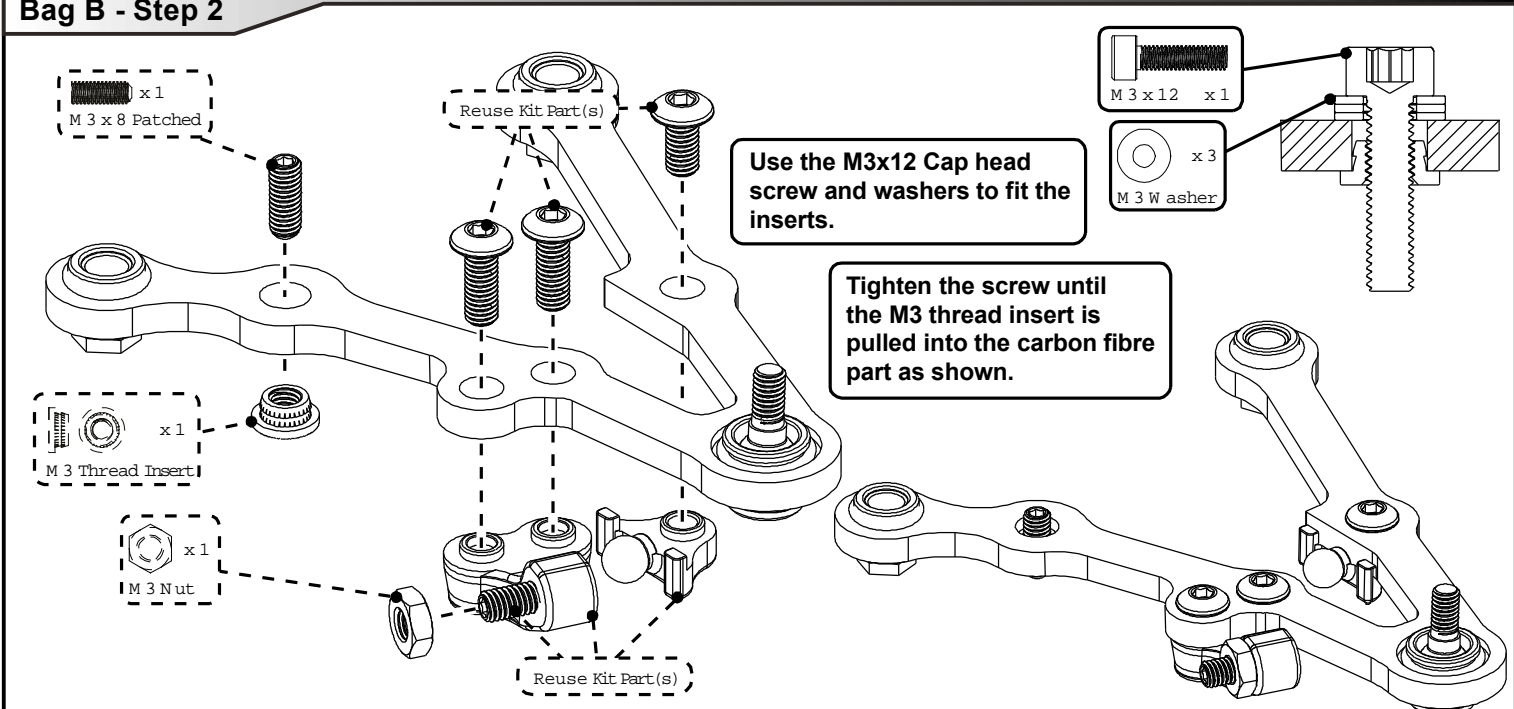

x 1
M 3 x 8 Patched

Reuse Kit Part(s)

Use the M3x12 Cap head screw and washers to fit the inserts.

x 1
M 3 x 12

x 3
M 3 Washer

Tighten the screw until the M3 thread insert is pulled into the carbon fibre part as shown.

x 1
M 3 Thread Insert

x 1
M 3 Nut

Reuse Kit Part(s)

Bag B - Step 3

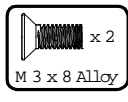
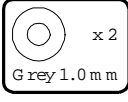
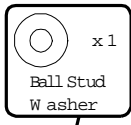

IMPORTANT
Always use an alloy screw to prevent damage to the chassis in the event of a heavy crash.

IMPORTANT
Only use the Ball Stud Washer (Shiny, silver, magnetic washer) in the specified location. If a normal washer is used it will lock up the ball joint.

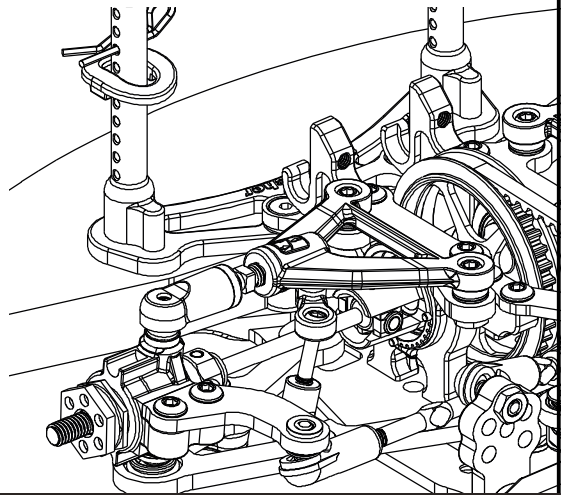
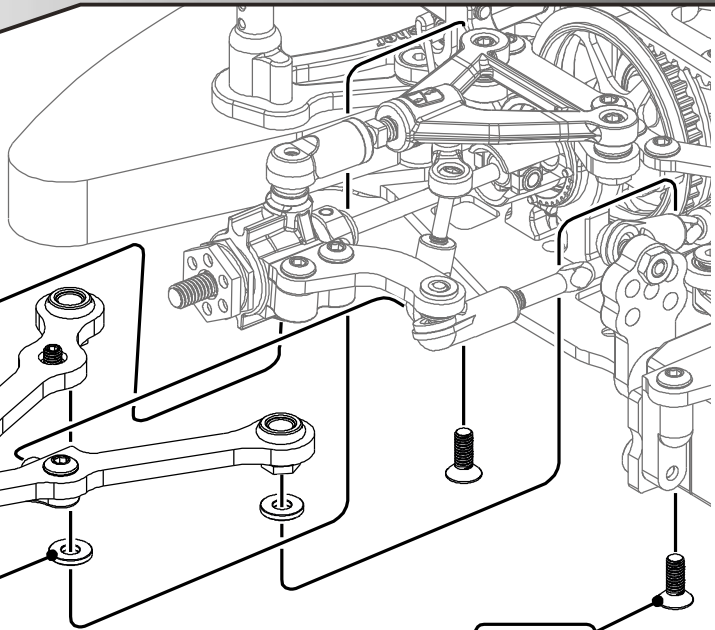

Bag C - Step 1

NOTE
O'ring in the counterbore.

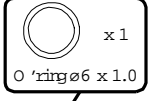
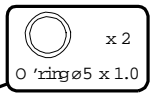

Ensure O'ring is correctly seated into the groove on the sockets.

Use pliers to insert pivot ball into socket.

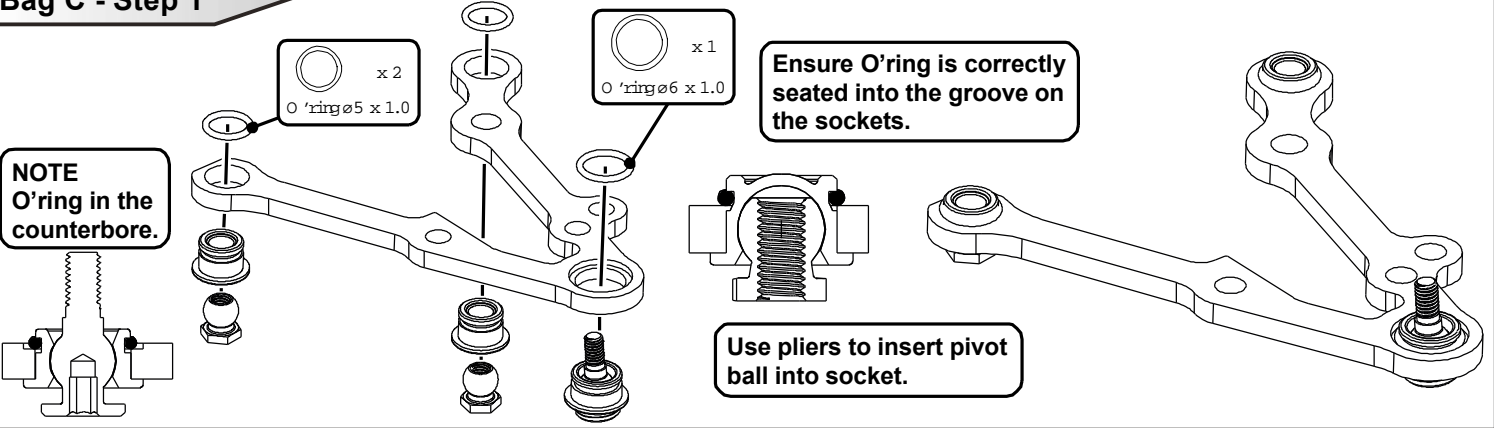

Bag C - Step 2



Use the M3x12 Cap head screw and washers to fit the inserts.

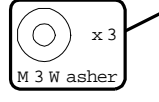
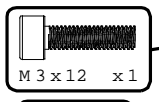

Tighten the screw until the M3 thread insert is pulled into the carbon fibre part as shown.

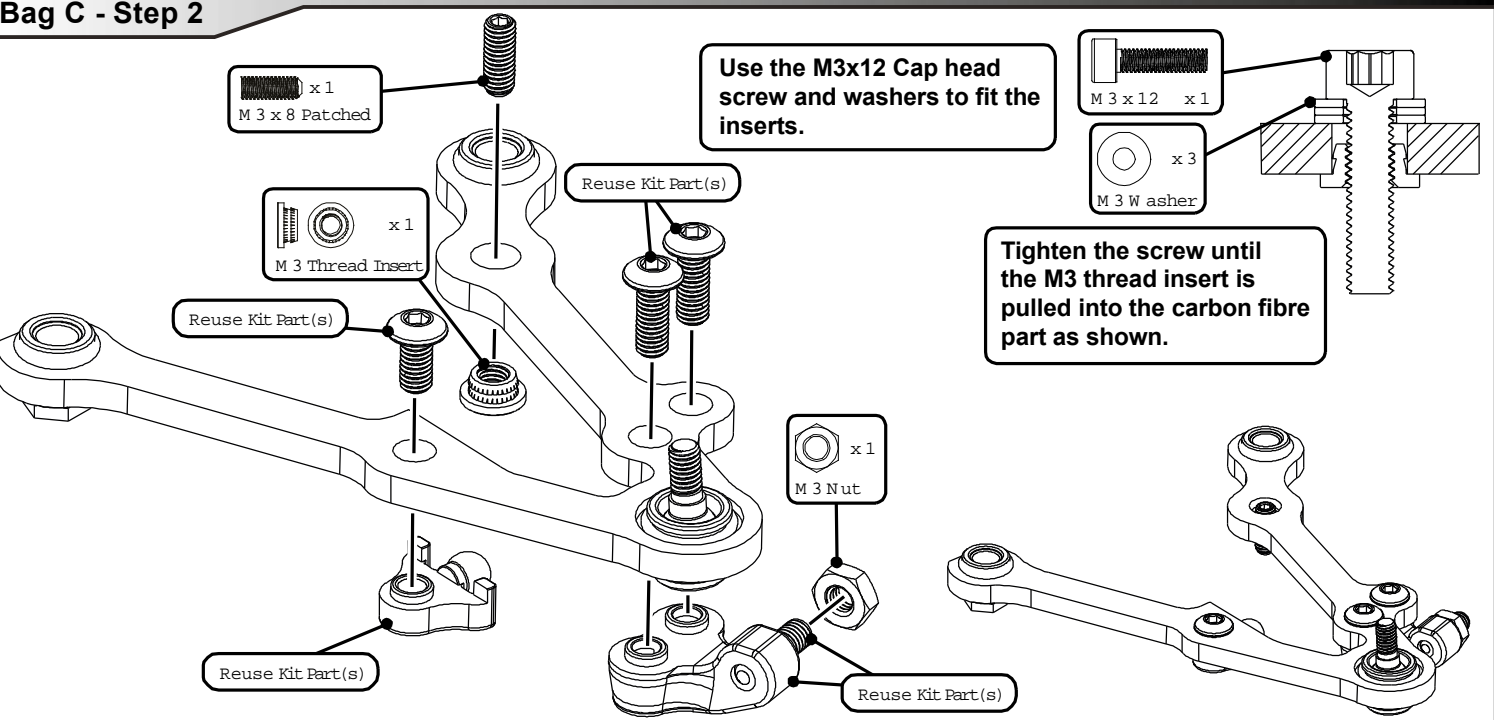
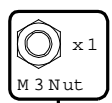

Bag C - Step 3

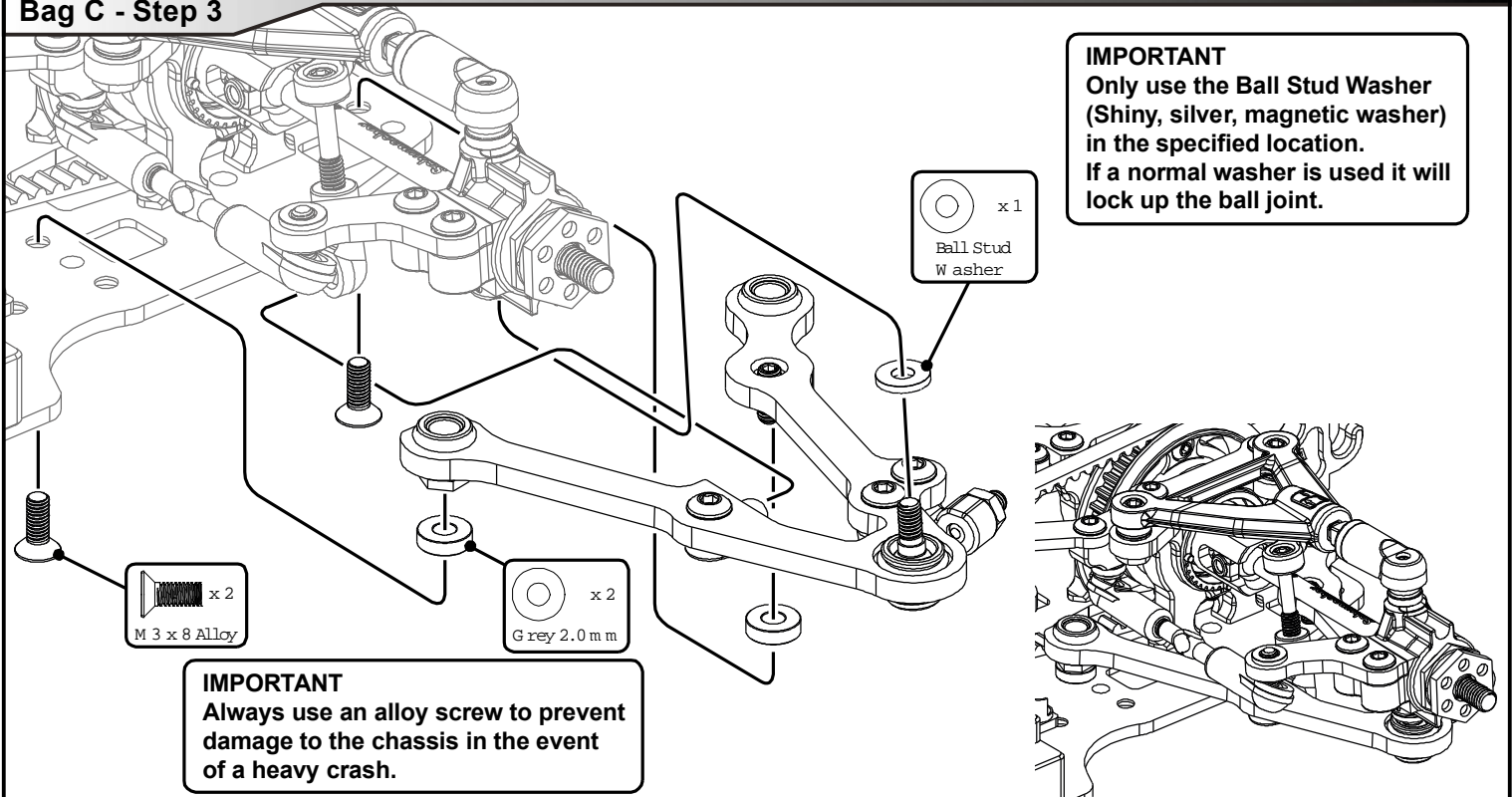

Bag D - Step 1

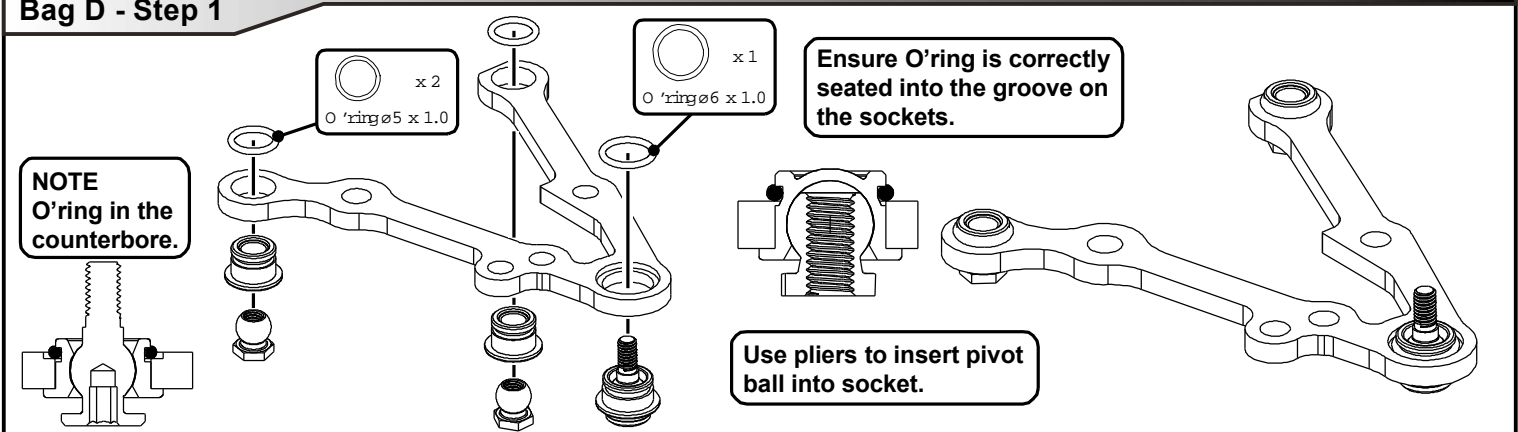

Bag D - Step 2

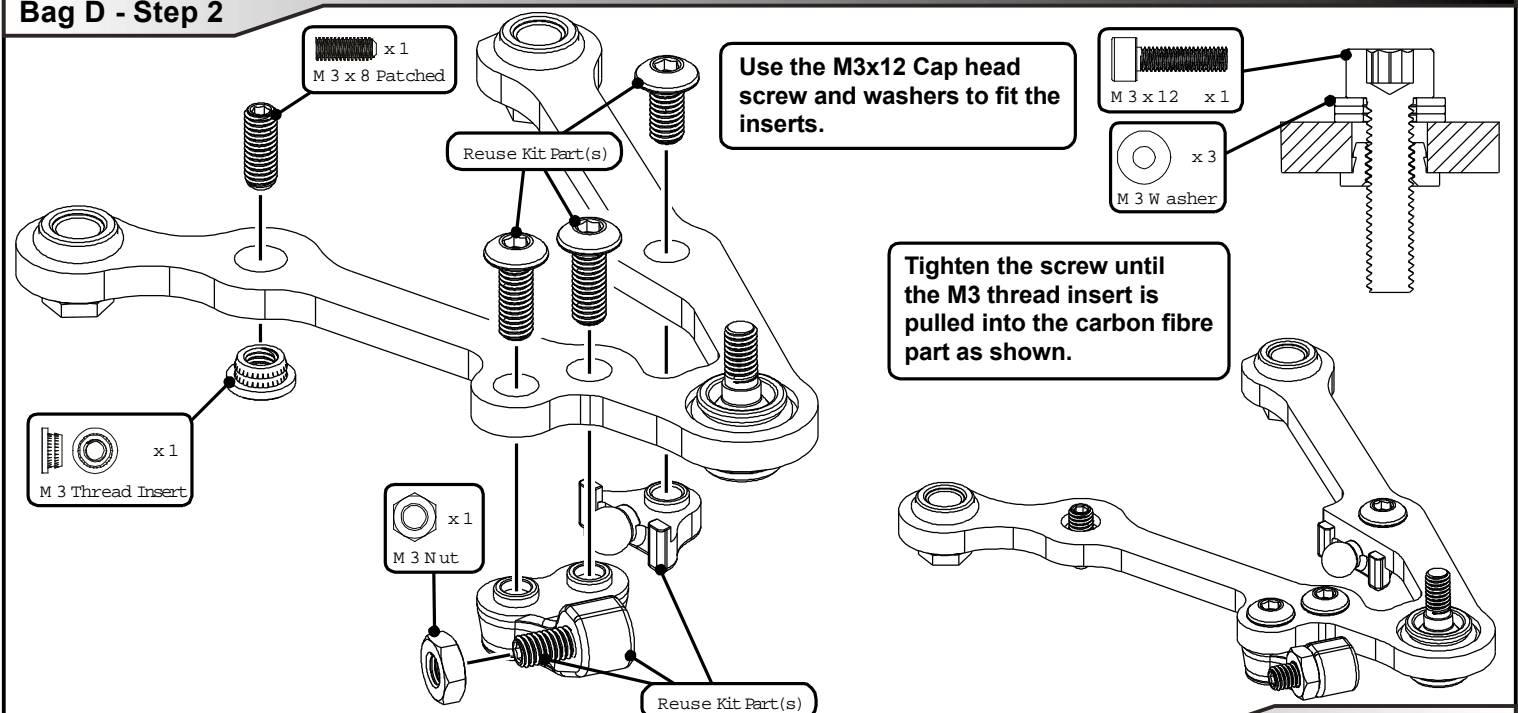

Bag D - Step 3

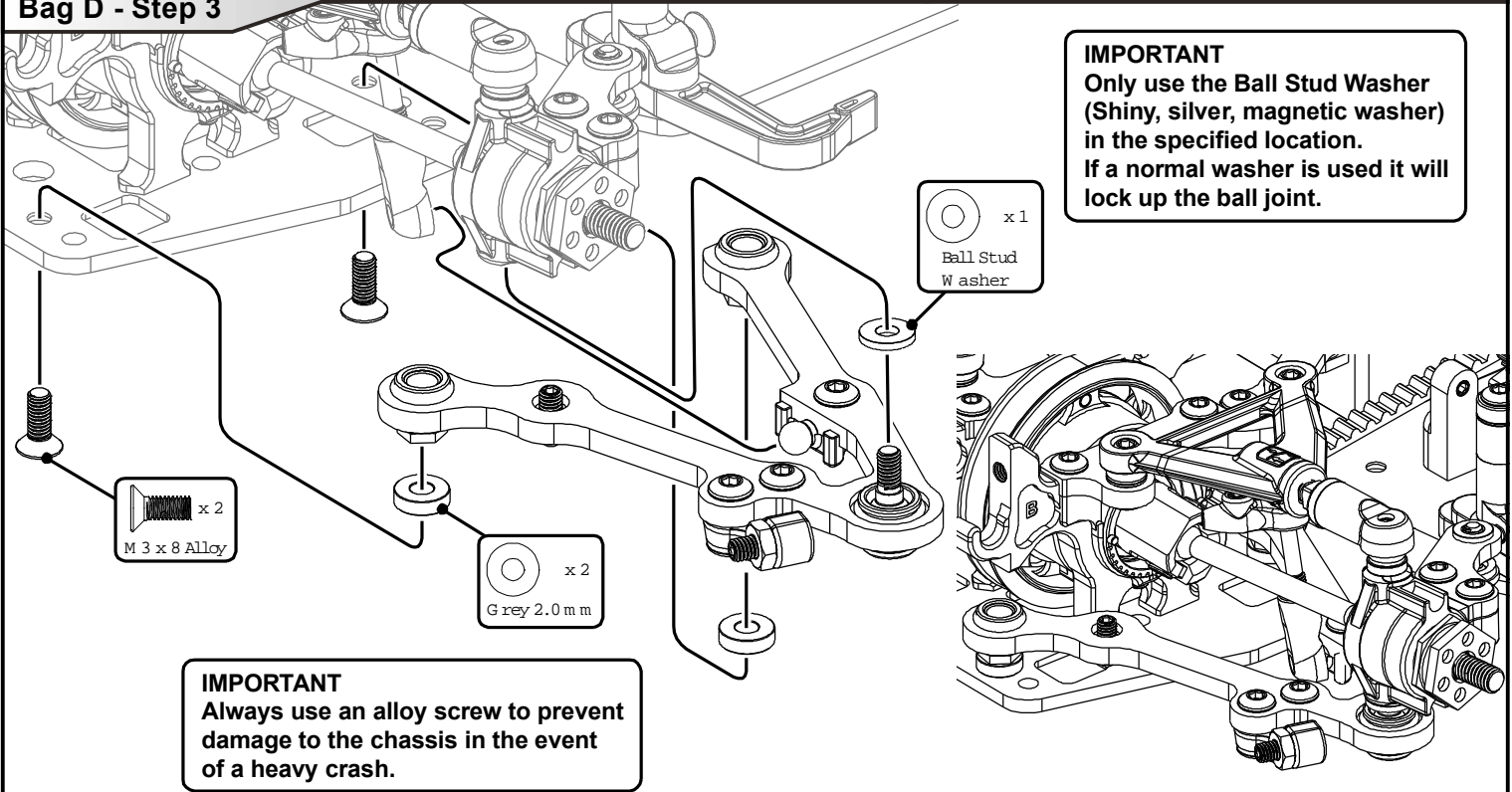

Bag E - Step 1

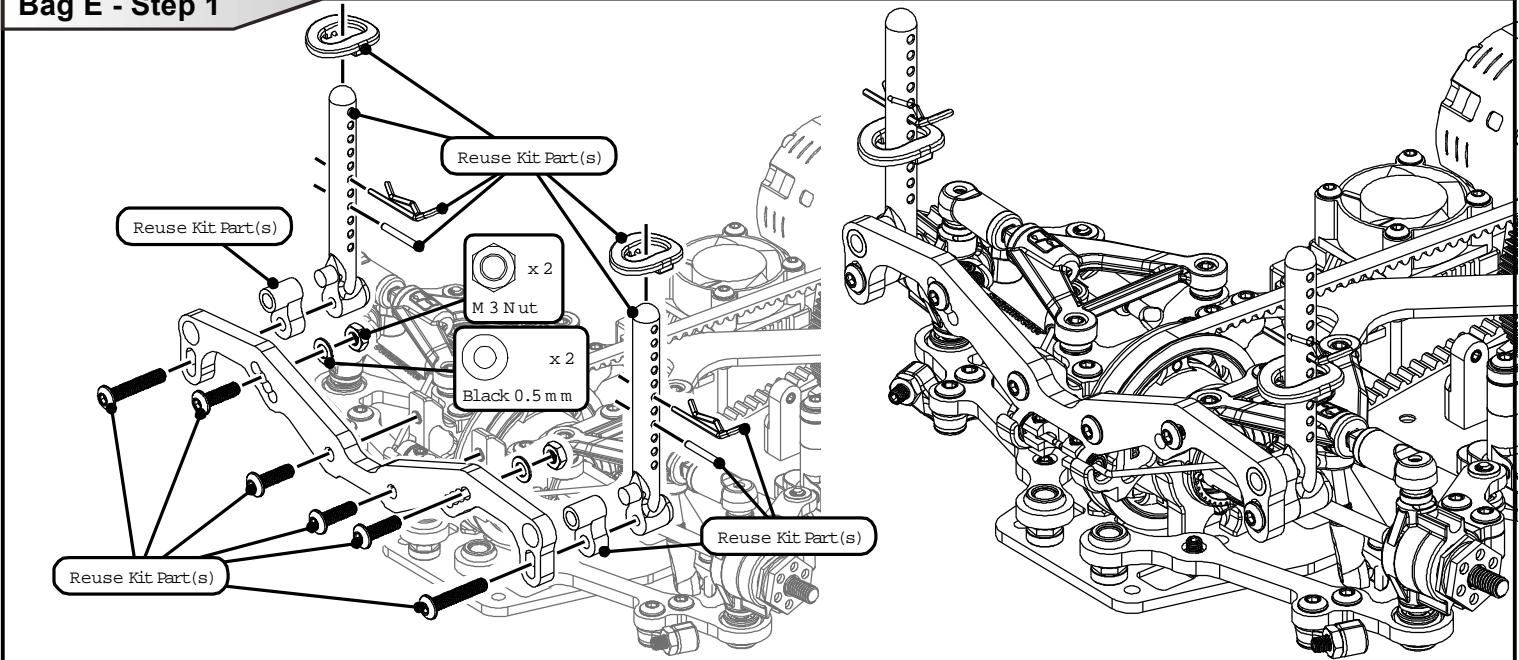

Bag E - Step 2

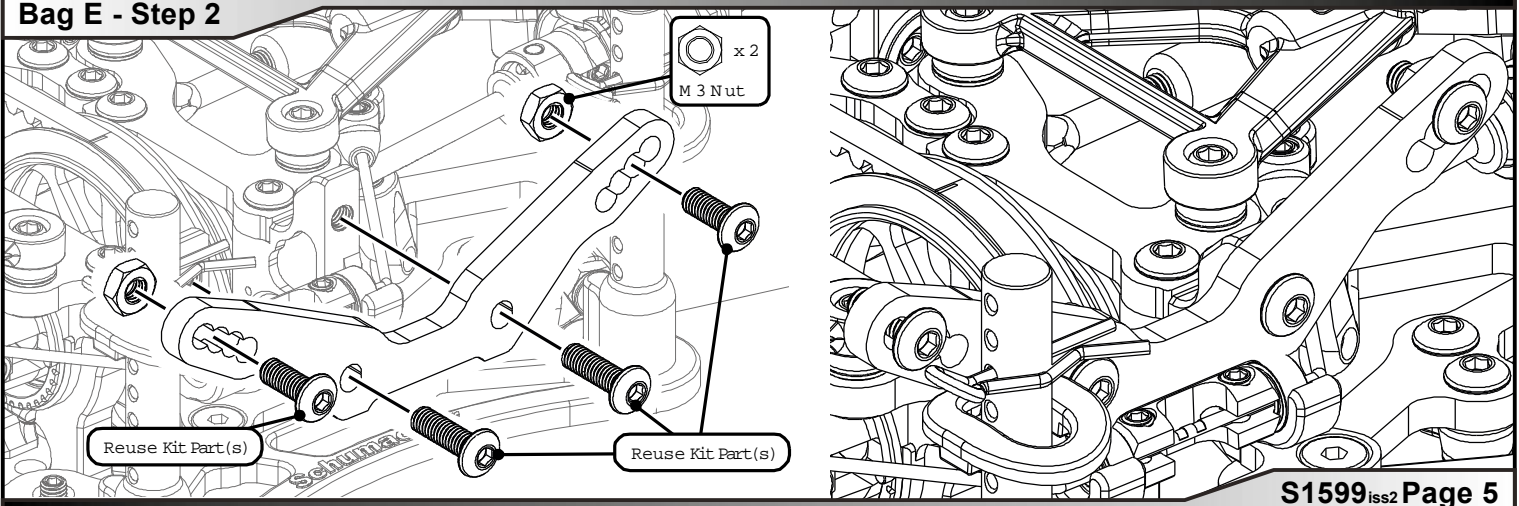

Bag E - Step 3

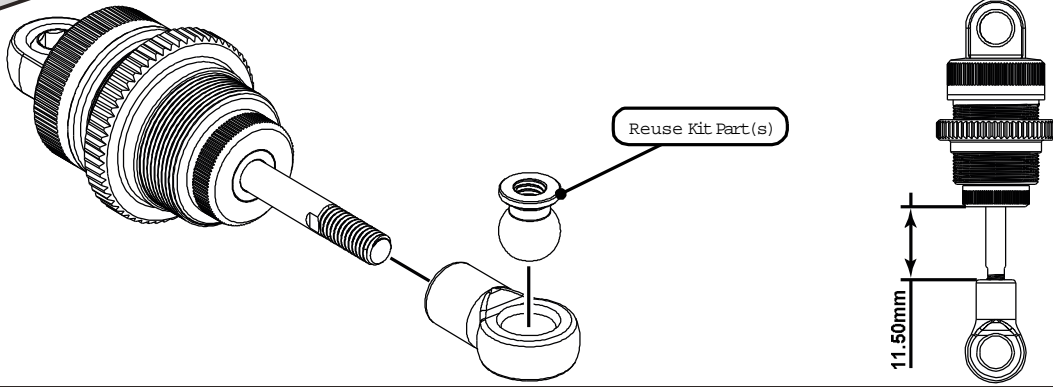

Bag E - Step 4

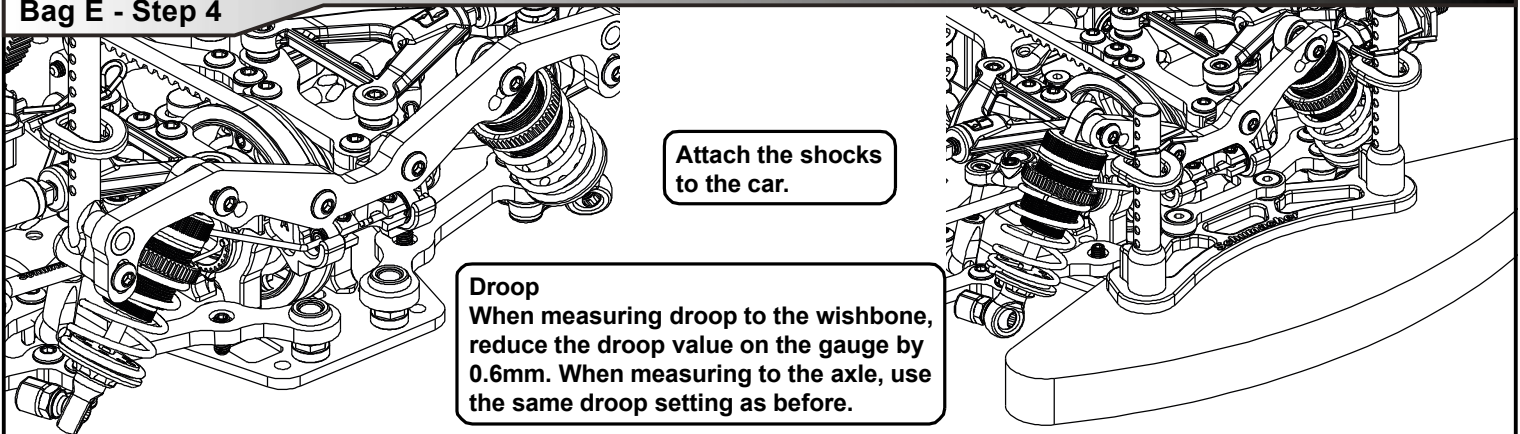

Horizontal Body Post Option

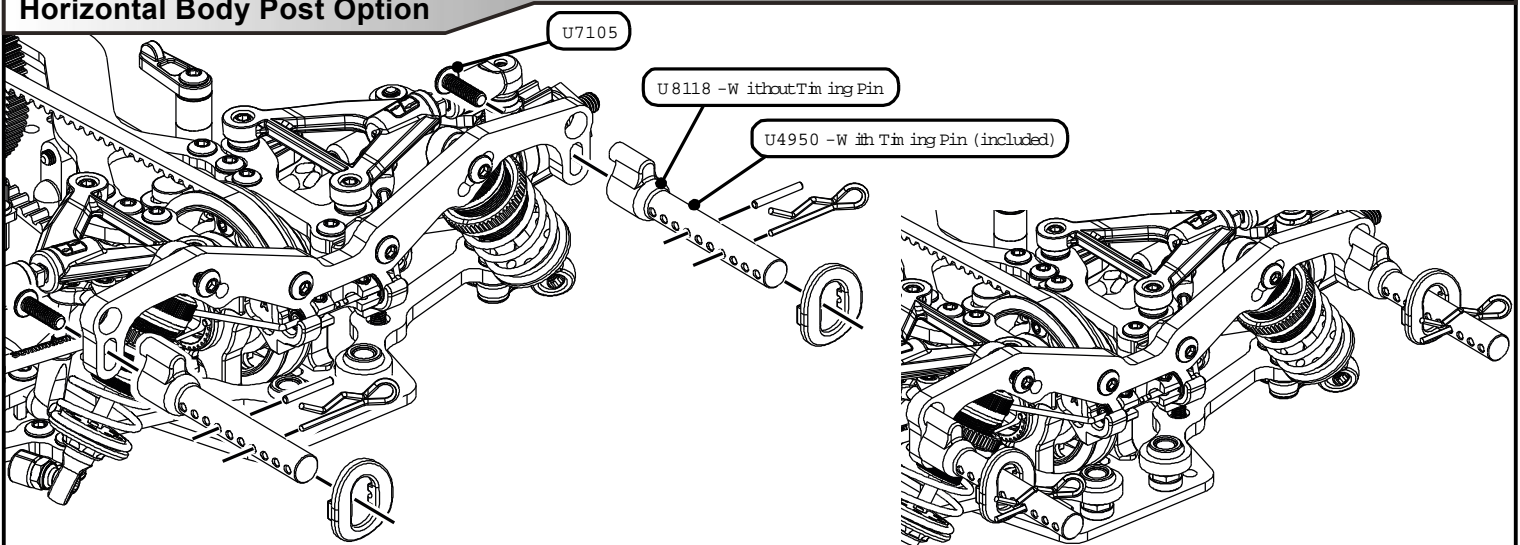

Parts List

	U8162 - Front Pivot Ball Wishbones U8163 - Rear Pivot Ball Wishbones		U8166 - 5.5mm Pivot Ball Socket (pk8)
	U8164 - Front Shock Mount (Pivot Ball) U8165 - Rear Shock Mount (Pivot Ball)		U4775 - Pivot Ball 5.5mm - (4pcs)
	U7431 - Rod End Socket (5.5mm) (pk4)		U3131 - SPEED PACK Alloy Spacers (pk18)
	U8167 - Pivot Ball Outer Socket (pr)		U4736 - Ball Stud Washer -CAT K2 - (8pcs)
			U4235 - M3 x 8mm Alloy Csk Screws pk10
			U4835 - SPEED PACK - M3 Steel Nut Black (pk8)
			U8133 - 6 x 1 'O'ring (pk10)
			U8168 - 5 x 1 'O'ring (pk10)